

Corte BB

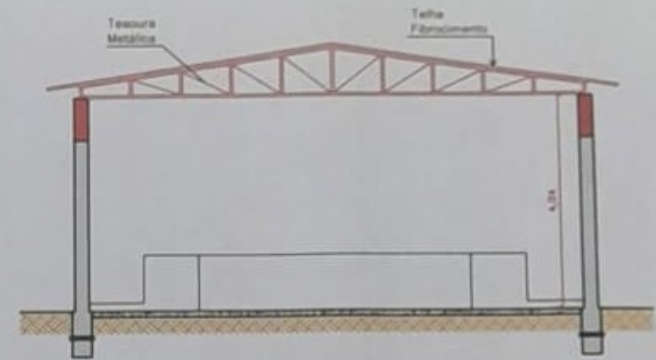

Escala - 1: 100



Corte AA

Escala - 1: 100

Legenda

Existente: 
 A Ampliar: 

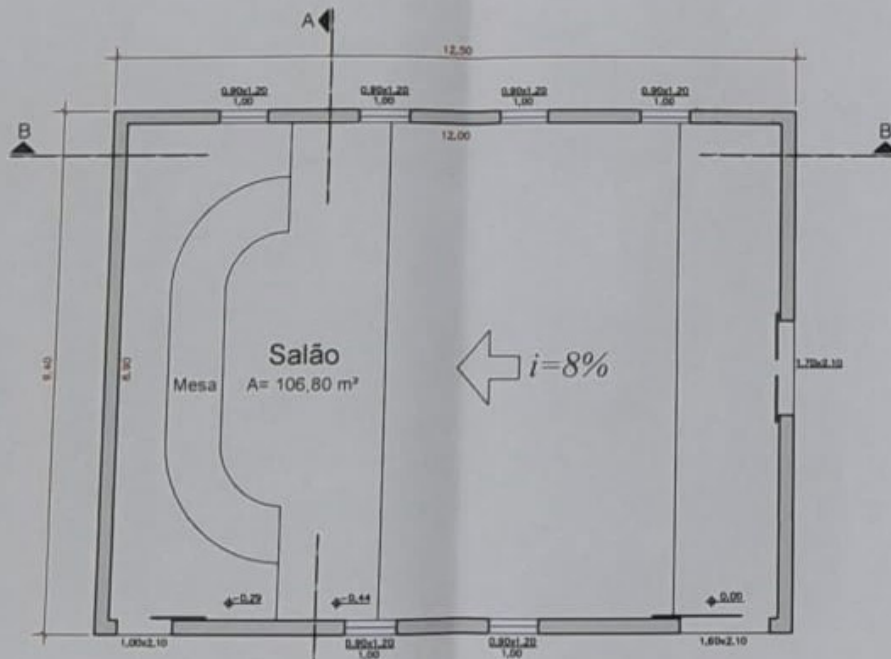

Planta Baixa

Escala - 1: 100

Planta e Cortes

FL. Única

Obra: Reforma de Auditório
Local: Praça Santana, nº 43
 Centro - Itapirapuã Paulista - SP.
Proprietário: Câmara Municipal
Escala: 1-100

Área a ser Reformada

117,50 m²

2620241026864

A.R.T.

Câmara Municipal
 Proprietário

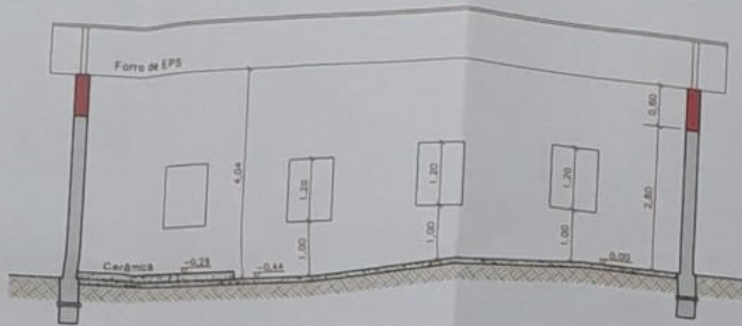

 Autor do Projeto e Responsável Técnico
Kevin Kaue Garcez
 Engenheiro Civil - CREA 5071129636

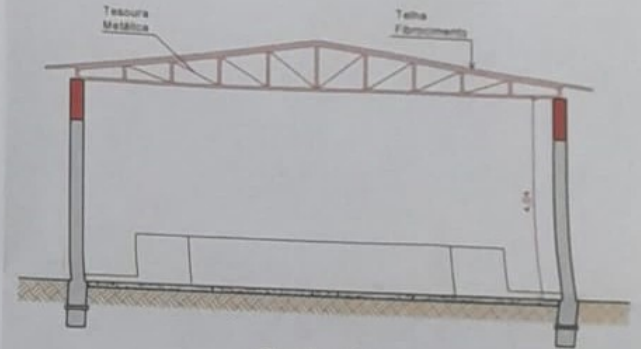

Corte BB
Escala - 1:75

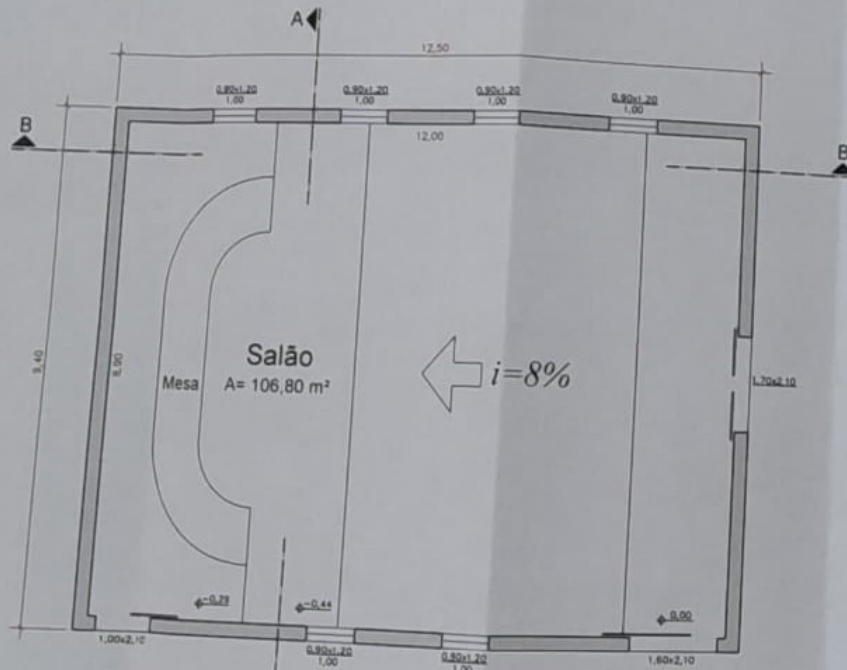

Corte AA
Escala - 1:75



Planta Baixa
Escala - 1:75

Legenda

Existente: 

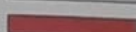
A Ampliar: 

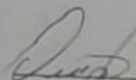
Planta e Cortes		FL. Única
Obra:	Reforma de Auditório	
Local:	Praça Santana, nº 43 Centro - Itapirapuã Paulista - SP.	
Proprietário:	Câmara Municipal	
Escala:	Indicadas	
Área a ser Reformada	117,50 m²	 Câmara Municipal Proprietário
	2620241026864 A.R.T.	

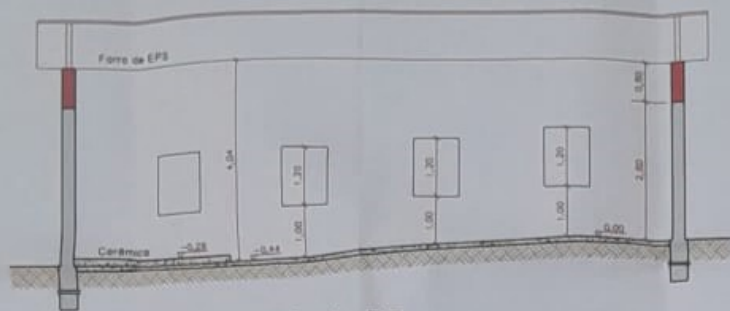

Corte BB

Escala - 1:75

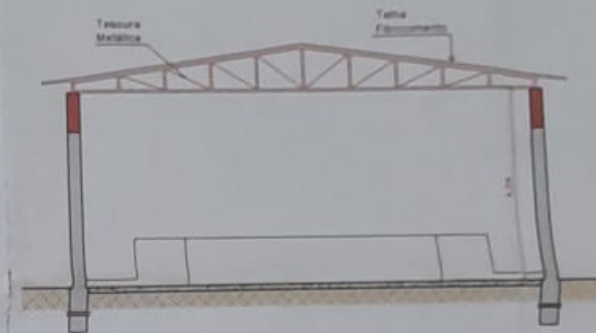

Corte AA

Escala - 1:75

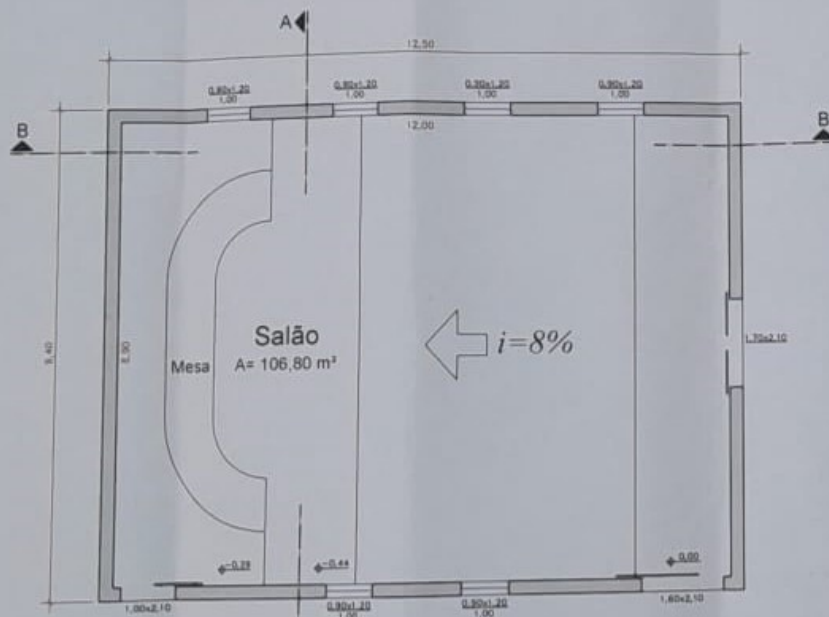

Planta Baixa

Escala - 1:75

Legenda

Existente:
 A Ampliar:

Planta e Cortes		FL. Única
Obra:	Reforma de Auditório	
Local:	Praça Santana, nº 43 Centro - Itapirapuã Paulista - SP.	
Proprietário:	Câmara Municipal	
Escala:	Indicadas	
Área a ser Reformada	117,50 m²	 Câmara Municipal Proprietário
	2620241026864 A.R.T.	